

# Standard Bearings in Tables

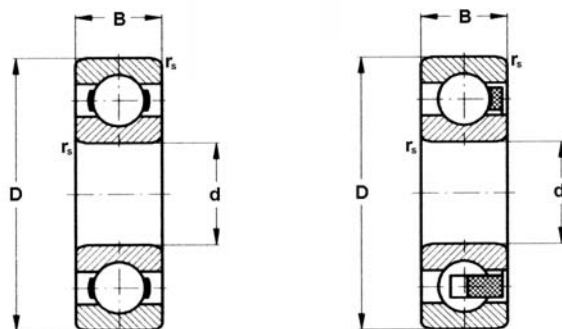

TNH

## Single Row Ball Bearings

Dimensions				Load capacity		Speed limit		Bearings identification		Weight
d	D	B	$r_{s \min}$	dynamic $C_r$	static $C_{or}$	with plastic lubricant	with oil	Standard	TNH	
[ mm ]				[ N ]		[ $\text{min}^{-1}$ ]				[ g ]
3	10	4	0,15	490	216	40 000	50 000	623	-	1,5
4	13	5	0,2	900	415	38 000	45 000	624	624TNH	3,2
	16	5	0,3	1 430	735	35 000	42 000	634	634TNH	5
5	16	5	0,3	1 430	735	35 000	42 000	625	625TNH	4,7
	19	6	0,3	2 120	1 160	35 000	42 000	635	-	9
	19	6	0,3	1 890	1 050	35 000	42 000	-	635TNH	9
6	16	4	0,2	1 550	722	35 000	42 000	-	618/6TNH	3,5
	19	6	0,3	2 120	1 160	35 000	42 000	626	-	8
	19	6	0,3	1 890	1 050	35 000	42 000	-	626TNH	8
7	19	6	0,3	2 120	1 160	35 000	42 000	607	-	7,5
	19	6	0,3	1 890	1 050	35 000	42 000	-	607TNH	7,5
	22	7	0,3	2 500	1 340	35 000	42 000	627	627TNH	12,3
8	16	4	0,2	1 550	722	35 000	42 000	-	618/8TNH	3
	22	7	0,3	2 500	1 340	35 000	42 000	608	608TNH	12
9	24	7	0,3	2 800	1 530	35 000	42 000	609	609TNH	14
	26	8	0,3	3 550	1 930	35 000	42 000	629	629TNH	20
10	22	6	0,3	2 080	1 270	34 000	40 000	-	61900TNH♦	9,6
	26	8	0,3	3 910	1 960	28 000	33 000	6000	6000TNH	19
	30	9	0,6	4 500	2 240	25 000	30 000	6200	6200TNH	31
12	28	8	0,3	4 500	2 240	25 000	30 000	6001	6001TNH	22
	30	8	0,3	4 500	2 240	25 000	30 000	16101	16101TNH	25
	32	10	0,6	6 100	3 100	22 000	27 000	6201	6201TNH	37
15	35	11	0,6	7100	3760	13 000	24 000	-	6202TNH	45
17	30	7	0,3	2 460	1 870	22 000	26 000	-	61903TNH♦	18

Note: Marked bearings (♦) are not routinely produced and their delivery is to be negotiated with producer.

# Standard Bearings in Tables

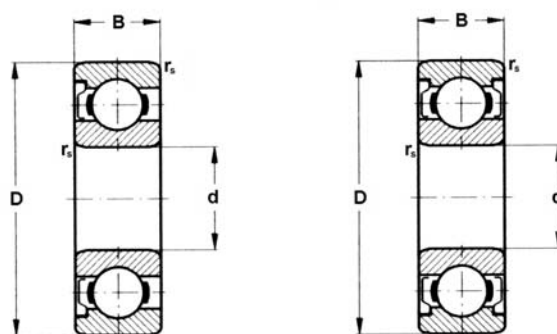

ZR (ZRTNH)

2ZR (2ZRTNH)

## Single Row Ball Bearings with Shields

Dimensions				Load capacity		Speed limit		Bearings identification		Weight
d	D	B	$r_{s \min}$	dynamic $C_r$	static $C_{or}$	with plastic lubricant	with oil	ZR	2ZR	
[ mm ]				[ N ]		[ $\text{min}^{-1}$ ]				[ g ]
3	10	4	0,15	490	216	40 000	50 000	<b>623ZR #</b>	<b>623-2ZR #</b>	1,5
4	13	5	0,2	900	415	38 000	45 000	<b>624ZR</b>	<b>624-2ZR</b>	3,2
	16	5	0,3	1 430	735	35 000	42 000	<b>634ZR</b>	<b>634-2ZR #</b>	5
5	16	5	0,3	1 430	735	35 000	42 000	<b>625ZR</b>	<b>625-2ZR #</b>	4,7
	19	6	0,3	2 120	1 160	35 000	42 000	<b>635ZR</b>	<b>635-2ZR</b>	9
6	19	6	0,3	2 120	1 160	35 000	42 000	<b>626ZR</b>	<b>626-2ZR</b>	8
7	19	6	0,3	2 120	1 160	35 000	42 000	<b>607ZR</b>	<b>607-2ZR</b>	7,5
	22	7	0,3	2 500	1 340	35 000	42 000	<b>627ZR</b>	<b>627-2ZR</b>	12,3
8	22	7	0,3	2 500	1 340	35 000	42 000	<b>608ZR</b>	<b>608-2ZR</b>	12
9	24	7	0,3	2 800	1 530	35 000	42 000	<b>609ZR</b>	<b>609-2ZR</b>	14
	26	8	0,3	3 550	1 930	35 000	42 000	<b>629ZR</b>	<b>629-2ZR</b>	20
10	22	6	0,3	2 080	1 270	34 000	40 000	61900ZRTNH♦	61900-2ZRTNH♦	9,6
	26	8	0,3	3 910	1 960	28 000	33 000	<b>6000ZR</b>	<b>6000-2ZR</b>	19
	30	9	0,6	4 500	2 240	25 000	30 000	<b>6200ZR</b>	<b>6200-2ZR #</b>	31
12	28	8	0,3	4 500	2 240	25 000	30 000	<b>6001ZR</b>	<b>6001-2ZR #</b>	22
	32	10	0,6	6 100	3 100	22 000	27 000	<b>6201ZR</b>	<b>6201-2ZR</b>	37
17	30	7	0,3	2 460	1 870	22 000	26 000	61903ZRTNH♦	61903-2ZRTNH♦	18

Note: Marked bearings (♦) are not routinely produced and their delivery is to be negotiated with producer.  
Bearings marked (#) are not produced in version with polyamide cage TNH

# Standard Bearings in Tables

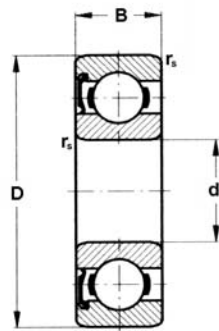

RSR (RSRTNH)

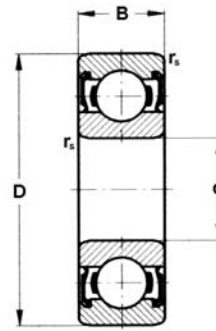

2RSR (2RSRTNH)

## Single Row Ball Bearings with Seals

Dimensions				Load capacity		Speed limit		Bearings identification		Weight
d	D	B	$r_{s \text{ min}}$	dynamic $C_r$	static $C_{or}$	with plastic lubricant	with oil	RSR	2RSR	
[ mm ]				[ N ]		[ $\text{min}^{-1}$ ]				[ g ]
5	19	6	0,3	2 120	1 160	22 000	42 000	635RSR	635-2RSR	9
6	19	6	0,3	2 120	1 160	22 000	42 000	626RSR	626-2RSR	8
7	19	6	0,3	2 120	1 160	22 000	42 000	607RSR	607-2RSR	7,5
	22	7	0,3	2 500	1 340	20 000	42 000	627RSR	627-2RSR	12,3
8	22	7	0,3	2 500	1 340	20 000	42 000	608RSR	608-2RSR	12
9	24	7	0,3	2 800	1 530	20 000	42 000	609RSR	609-2RSR	14
	26	8	0,3	3 550	1 930	19 000	42 000	629RSR	629-2RSR	20
10	22	6	0,3	2 460	1 270	34 000	40 000	61900RSRTNH*	61900-2RSRTNH*	9,6
	26	8	0,3	3 910	1 960	19 000	33 000	6000RSR	6000-2RSR	19
	30	9	0,6	4 500	2 240	17 000	30 000	6200RSR	6200-2RSR	31
12	28	8	0,3	4 500	2 240	17 000	30 000	6001RSR	6001-2RSR #	22
	32	10	0,6	6 100	3 100	16 000	27 000	6201RSR	6201-2RSR #	37
15	35	11	0,6	7100	3760	13 000	24 000	6202RSRTNH	6202-2RSRTNH	45
17	30	7	0,3	2 460	1 870	22 000	26 000	61903RSRTNH*	61903-2RSRTNH*	18

Note: Marked bearings (\*) are not routinely produced and their delivery is to be negotiated with producer.  
Marked bearings (#) are not produced in version with polyamide cage TNH