

# Standard Bearings in Tables

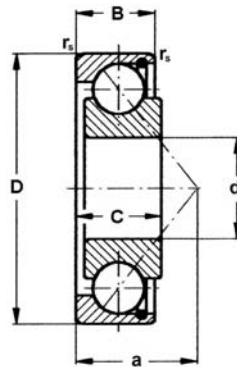

## Special Single Row Angular Contact Ball Bearings

Dimensions						Load capacity		Weight	Bearing identification
d	D	B	C	a	$r_{s \min}$	dynamic $C_r$	static $C_{or}$		
[ mm ]						[ N ]		[ g ]	
12	32	9,2	10	14,2	0,6	6 690	4 640	36,4	PLC 03-73
17	35	8,1	9	11	0,3	6 350	4 810	33,7	PLC 03-29-1
18	35	8,1	9	11	0,3	6 350	4 810	32,1	PLC 03-29-2

*Note: Bearings have no cage and have full quantity of balls.*