

Standard Bearings in Tables

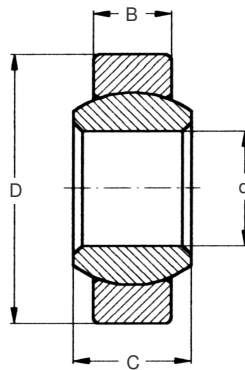

Spherical Plain Bearings (ČSN 02 3515)

Dimensions				Weight	Bearing identification
d	D	B	C		
[mm]				[g]	
4	12	3	5	2,7	GE 4
5	14	4	6	4,7	GE 5
6	14	4	6	4,3	GE 6
8	16	5	8	6,9	GE 8
10	19	6	9	11,3	GE 10♦
12	22	7	10	16,4	GE 12♦
15	26	9	12	27,4	GE 15♦
17	30	10	14	41,6	GE 17♦
20	35	12	16	66,2	GE 20♦

Note: Marked bearings (♦) are not routinely produced and their delivery is to be negotiated with producer.